

AVAILABLE

Rivertown Crossings, Former Sears

3622 Rivertown Parkway, Grandville, MI 49418



DETAILS

SPACE: 138,050 SF

ACRES: 12 Acres

AVAILABILITY: 2 ~60,000 SF Spaces

(Divisible Floor Plan Options Available)

AVAILABLE

Rivertown Crossings, Former Sears

3622 Rivertown Parkway, Grandville, MI 49418



SITE INFO

The former Sears property is in the Rivertown Crossings Mall, which besides Sears is anchored by Dick's Sporting Goods, JCPenney, Kohl's and Macy's. This is a vibrant retail area, with several other strip and shopping centers lining Rivertown Parkway such as the Wilson Town Center, Grandville Marketplace, Bucktown and Rivertown Center. Rivertown Crossings is also sandwiched between big box stores Meijer and Costco, with a Walmart just across the freeway.

AVAILABLE

Rivertown Crossings, Former Sears

3622 Rivertown Parkway, Grandville, MI 49418

DEMOGRAPHICS

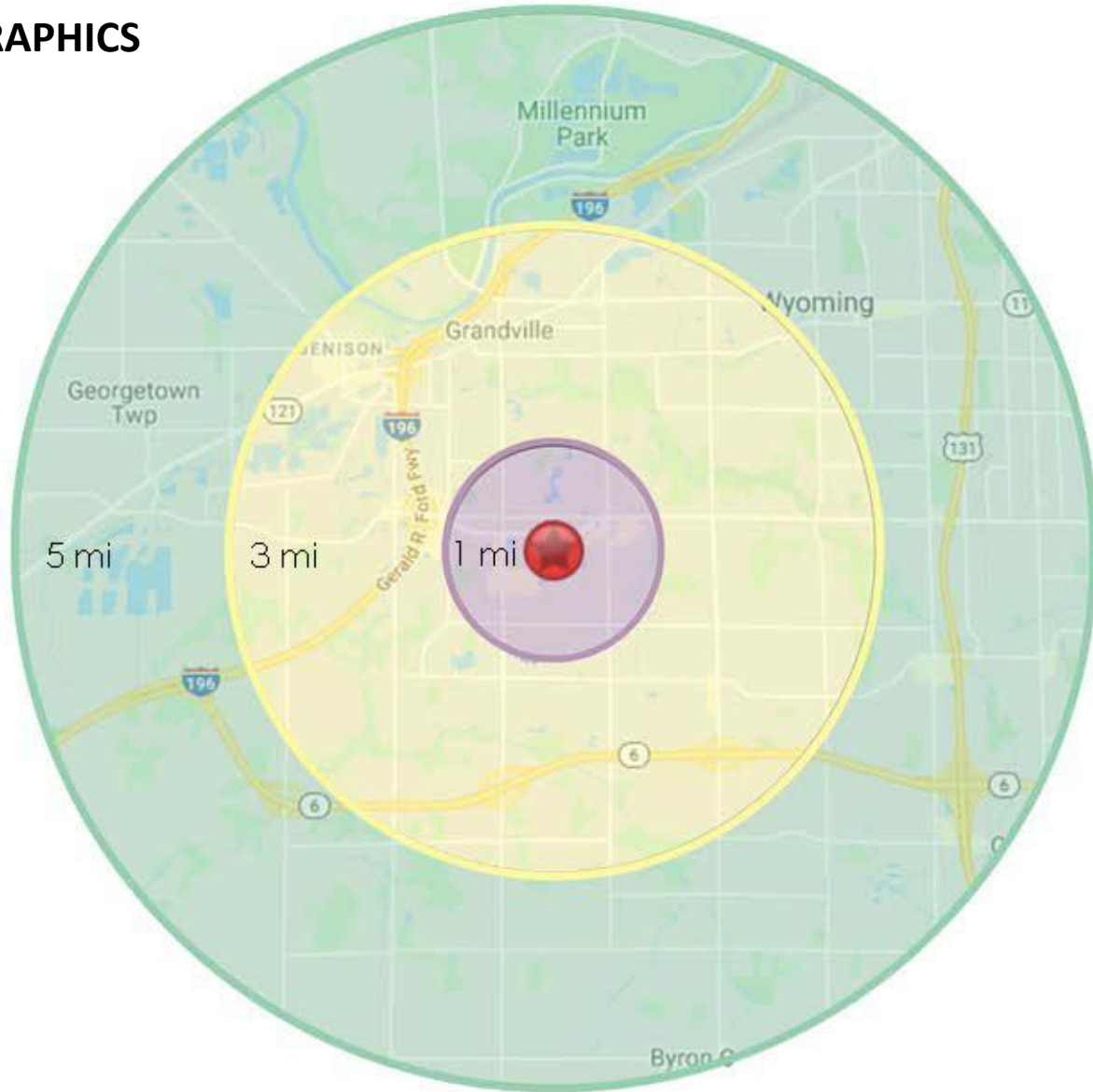

Area Demographics	1 Mile	3 Miles	5 Miles
Est Population (2025)	6,347	60,851	147,566
Average HH Income	\$107,150	\$108,831	\$106,156
Households	2,541	24,698	57,396
Median Age	40.2	36.6	36.7

Area Demographics	1 Mile	3 Miles	5 Miles
Total Businesses	393	2,280	4,779
Daytime Population	5,094	23,769	55,026

AVAILABLE

Rivertown Crossings, Former Sears

3622 Rivertown Parkway, Grandville, MI 49418

SITE PLAN



AVAILABLE

Rivertown Crossings, Former Sears

3622 Rivertown Parkway, Grandville, MI 49418

PROPOSED FIRST FLOOR PLAN 1

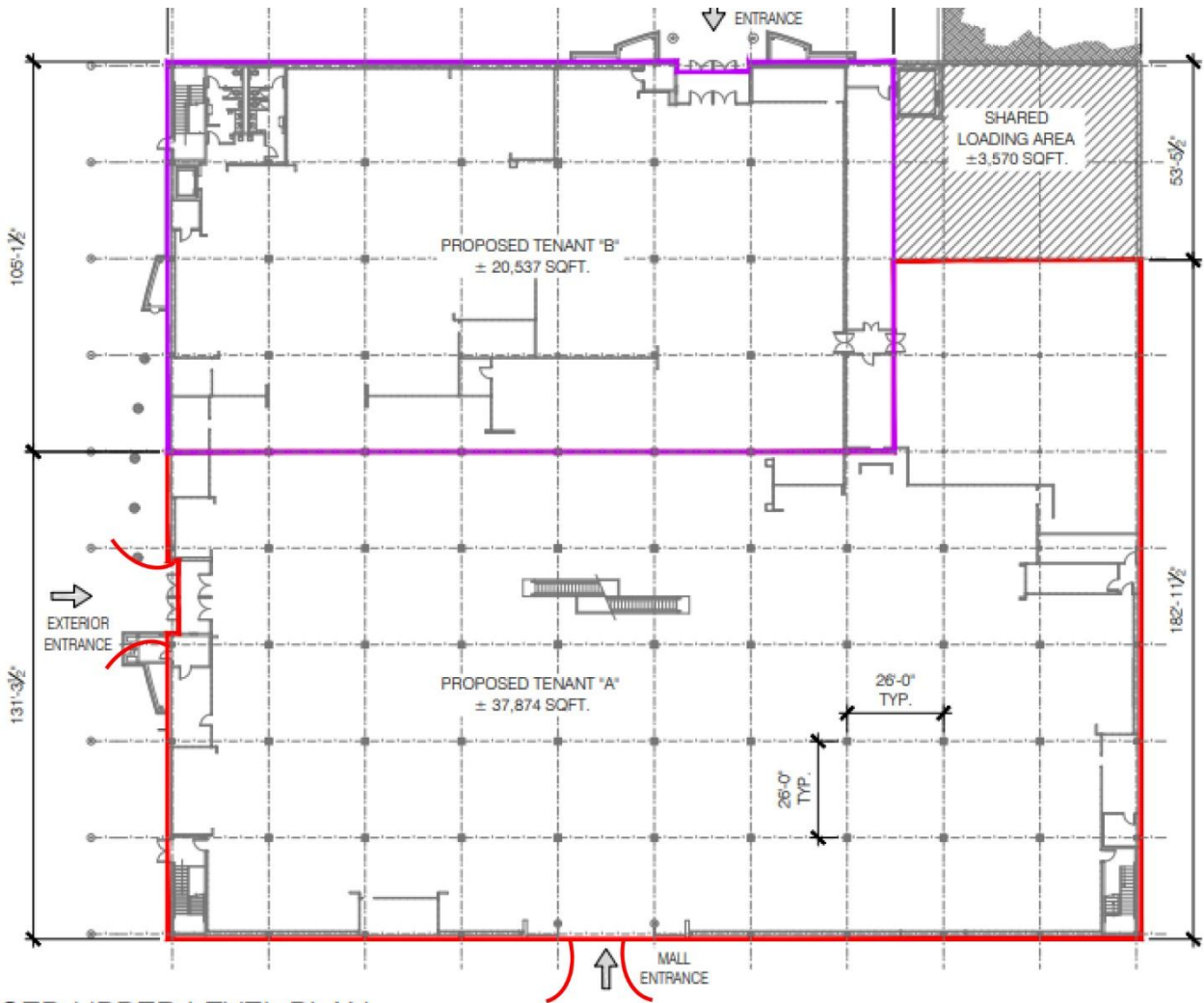

1 PROPOSED UPPER LEVEL PLAN
LOD1



SCALE: NTS

AVAILABLE

Rivertown Crossings, Former Sears

3622 Rivertown Parkway, Grandville, MI 49418

PROPOSED SECOND FLOOR PLAN 1

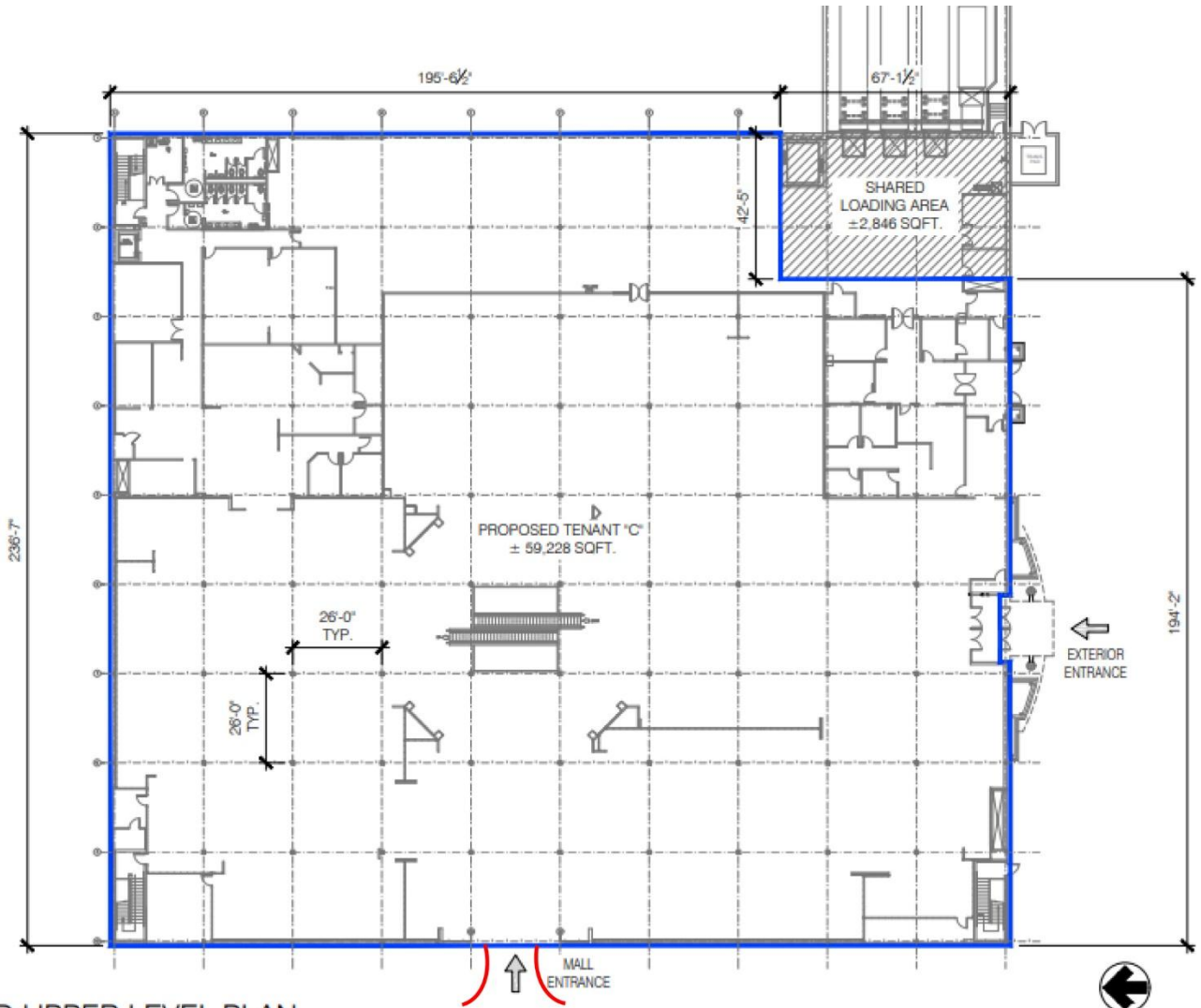

1
LOD2

PROPOSED UPPER LEVEL PLAN

NORTH
SCALE: NTS

AVAILABLE

Rivertown Crossings, Former Sears

3622 Rivertown Parkway, Grandville, MI 49418

PROPOSED FIRST FLOOR PLAN 2

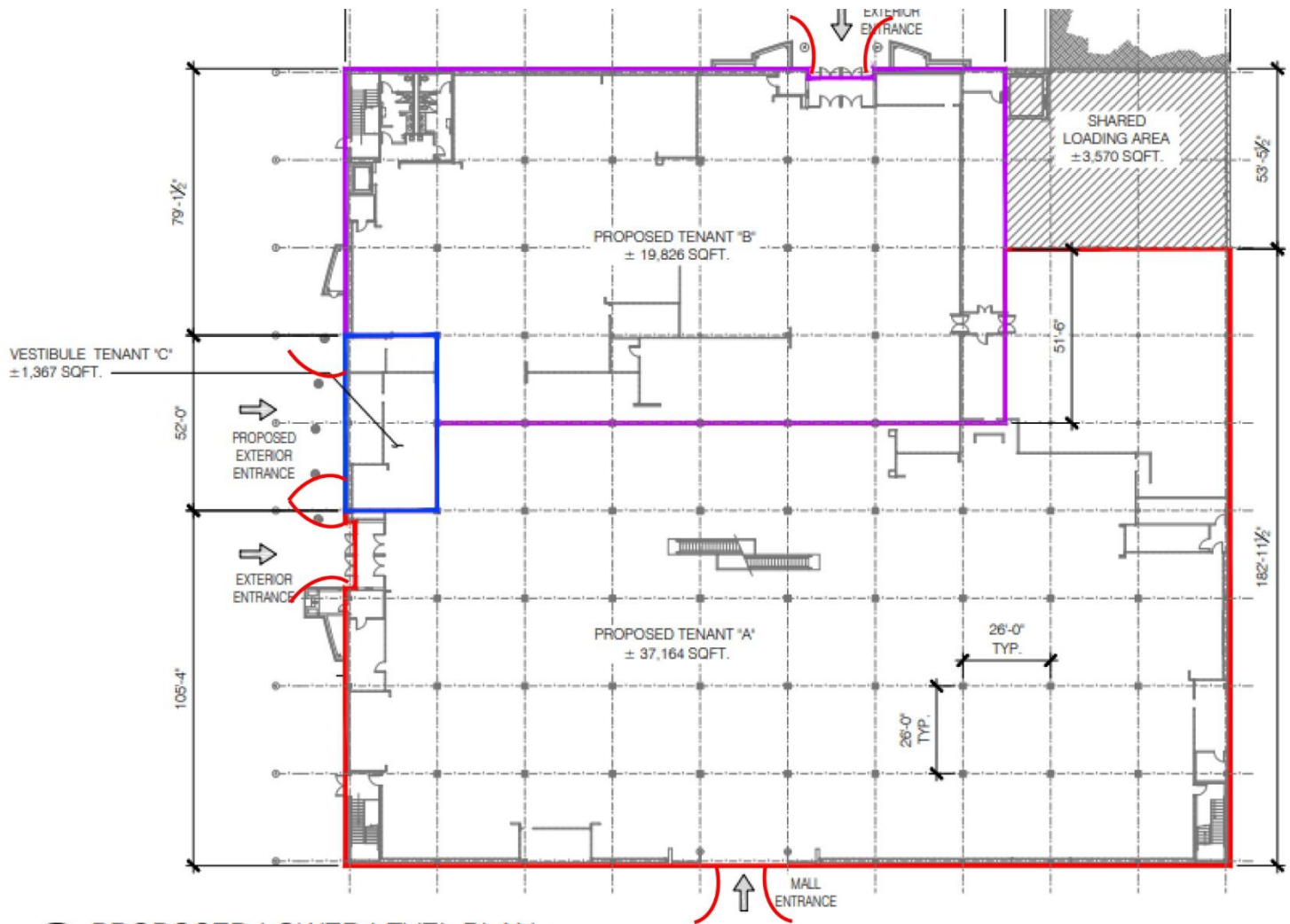

1 PROPOSED LOWER LEVEL PLAN
LOD1

SCALE: NTS

AVAILABLE

Rivertown Crossings, Former Sears

3622 Rivertown Parkway, Grandville, MI 49418

PROPOSED SECOND FLOOR PLAN 2

