

# RETAIL LEASE

West River Shopping Center - Outparcels

30000-30010 Grand River Ave, Farmington Hills, MI 48336



## TENANTS



Powered by Emagine

## DETAILS

### AVAILABLE SPACE

Unit 30000	2,760 SF
Frontage	65'
Ceiling Height	20.6'
Former bank with 3 drive-thru lanes	

Unit 30010	3,610 SF
Frontage	60'
Ceiling Height	20.8'

<b>PARKING AVAILABLE</b>	42 spaces Immediate Occupancy
--------------------------	----------------------------------

JIM BIERI 313.962.2800 jbieri@sbre1.com  
SEAN VON SCHWARZ 313.962.2800 sean@sbre1.com



# RETAIL LEASE

West River Shopping Center - Outparcels

30000-30010 Grand River Ave, Farmington Hills, MI 48336

## PHOTOS

Unit 30000



Unit 30010



### STOKAS BIERI REAL ESTATE

660 Woodward Ave, Ste 1500, Detroit, MI 48226

[www.StokasBieri.com](http://www.StokasBieri.com)



**JIM BIERI** 313.962.2800 [jbieri@sbre1.com](mailto:jbieri@sbre1.com)

**SEAN VON SCHWARZ** 313.962.2800 [sean@sbre1.com](mailto:sean@sbre1.com)



@StokasBieriRE





# RETAIL LEASE

West River Shopping Center - Outparcels

30000-30010 Grand River Ave, Farmington Hills, MI 48336

## DEMOGRAPHICS



Area Demographics	1 Mile	3 Miles	5 Miles
Est Population (2018)	11,042	77,238	217,005
Average HH Income	\$70,462	\$87,412	\$90,716
Households	4,905	33,568	95,429
Median Age	40.3	41.4	41.8

Daytime Demographics	1 Mile	3 Miles	5 Miles
Total Businesses	408	3,358	12,492
Daytime Population	6,964	60,701	227,532



# RETAIL LEASE

West River Shopping Center - Outparcels

30000-30010 Grand River Ave, Farmington Hills, MI 48336

## SITE PLAN

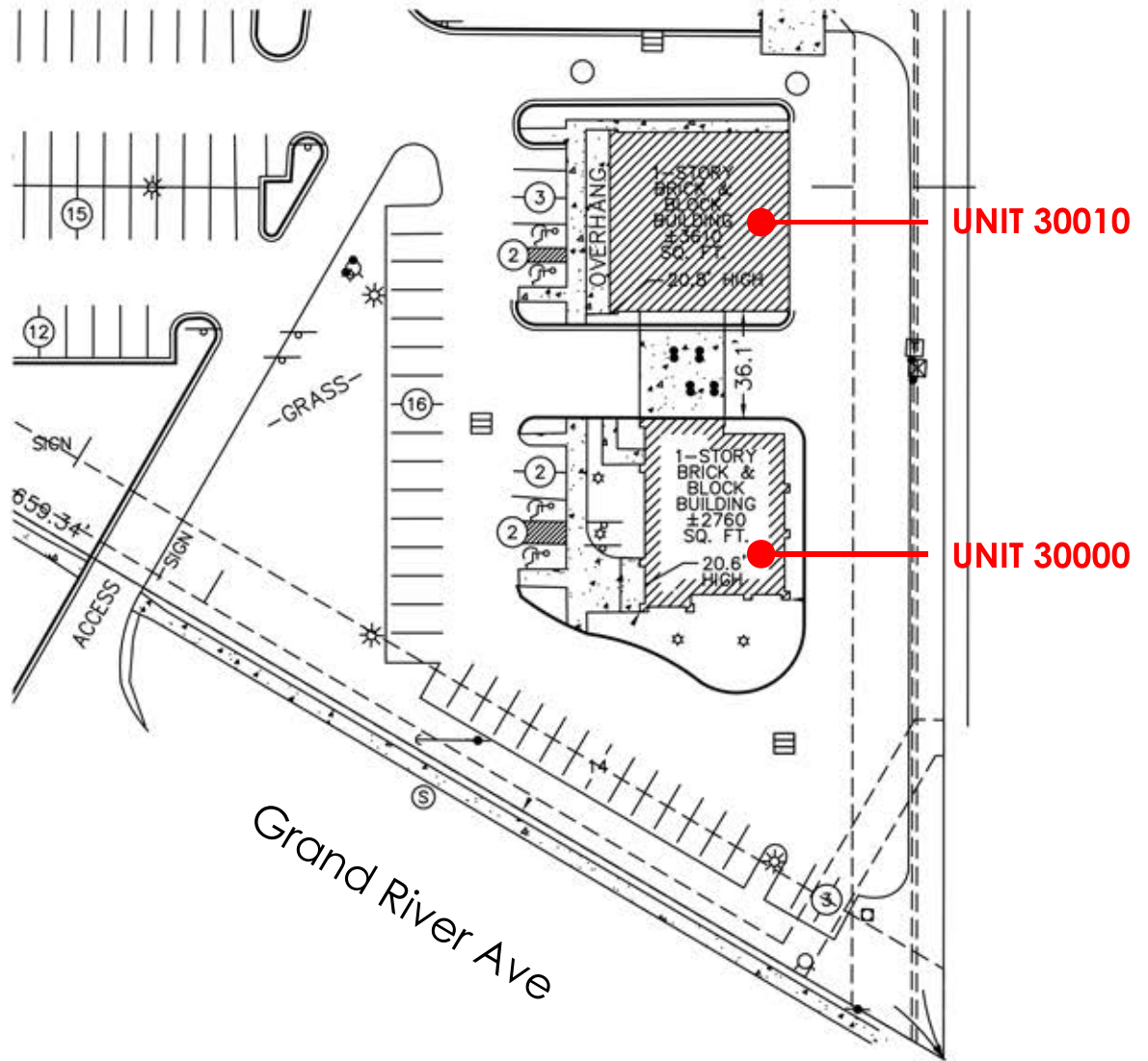

### STOKAS BIERI REAL ESTATE

660 Woodward Ave, Ste 1500, Detroit, MI 48226

[www.StokasBieri.com](http://www.StokasBieri.com)



**JIM BIERI** 313.962.2800 [jbieri@sbre1.com](mailto:jbieri@sbre1.com)

**SEAN VON SCHWARZ** 313.962.2800 [sean@sbre1.com](mailto:sean@sbre1.com)



@StokasBieriRE